

09.08/19

See Sheet 1A For Index of Sheets
 See Sheet 1B For Conventional Symbols
 See Sheet 1C Survey Control Sheet

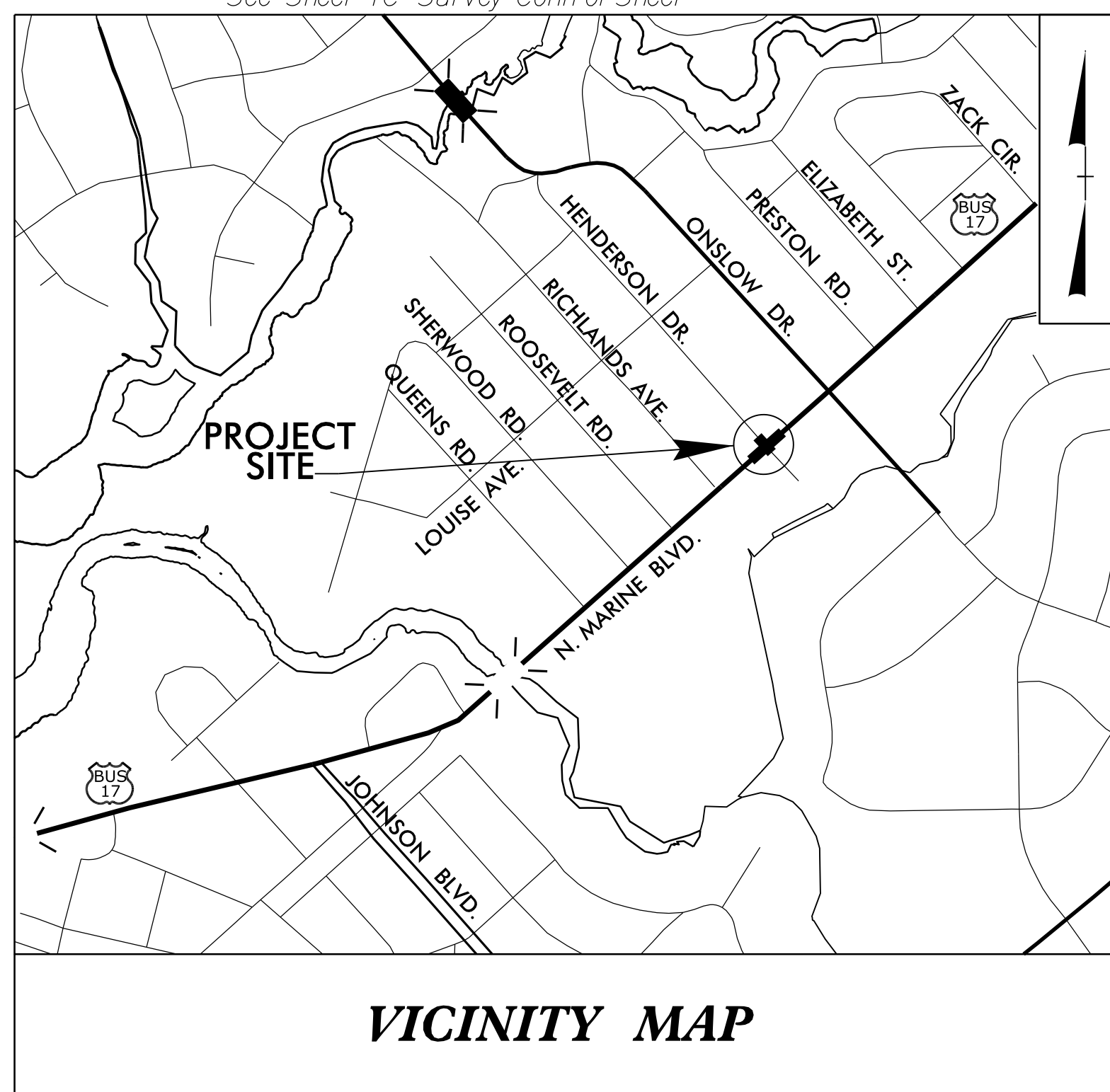

VICINITY MAP

65% SUBMITTAL - JULY 19, 2019

STATE OF NORTH CAROLINA
 DIVISION OF HIGHWAYS

ONSLOW COUNTY

**LOCATION: INTERSECTION IMPROVEMENT AT US 17 BUSINESS
 (N. MARINE BLVD.) AND SR 1336 (HENDERSON DR.)
 IN ONSLOW COUNTY**

**TYPE OF WORK: GRADING, DRAINAGE, PAVING, SIGNAL, AND
 PAVEMENT MARKING**

STATE	STATE PROJECT REFERENCE NO.	SHEET NO.	TOTAL SHEETS
N.C.	U-5950	1	
STATE PROJ. NO.	F.A. PROJ. NO.	DESCRIPTION	
46895.1.1	N/A	PE	

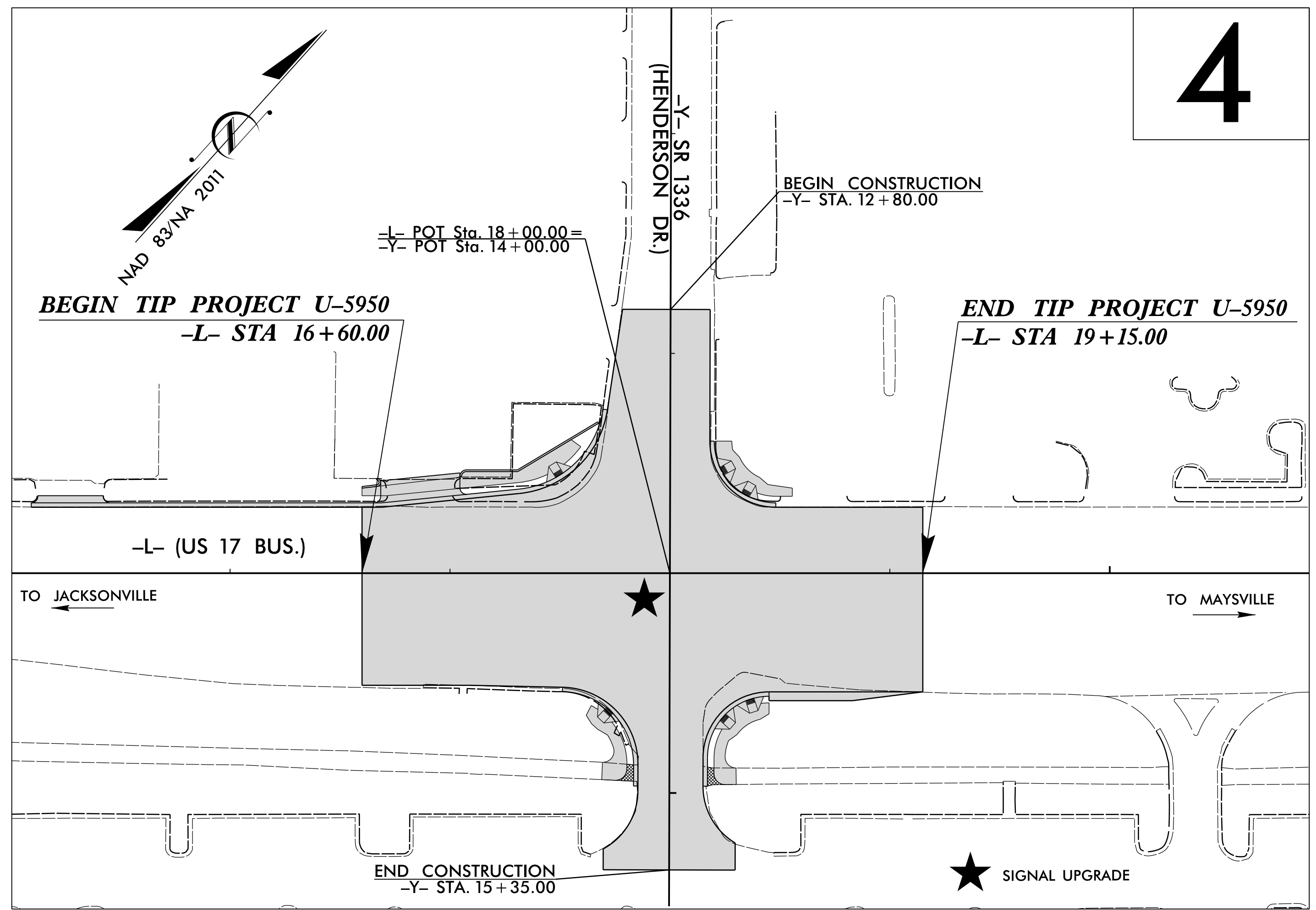

THIS PROJECT IS LOCATED WITHIN THE MUNICIPAL BOUNDARIES OF THE CITY OF JACKSONVILLE
 CLEARING ON THIS PROJECT SHALL BE PERFORMED TO THE LIMITS ESTABLISHED BY METHOD III MOD.

DOCUMENT NOT CONSIDERED FINAL
 UNLESS ALL SIGNATURES COMPLETED

CONTRACT: U-5950

CONTRACT:

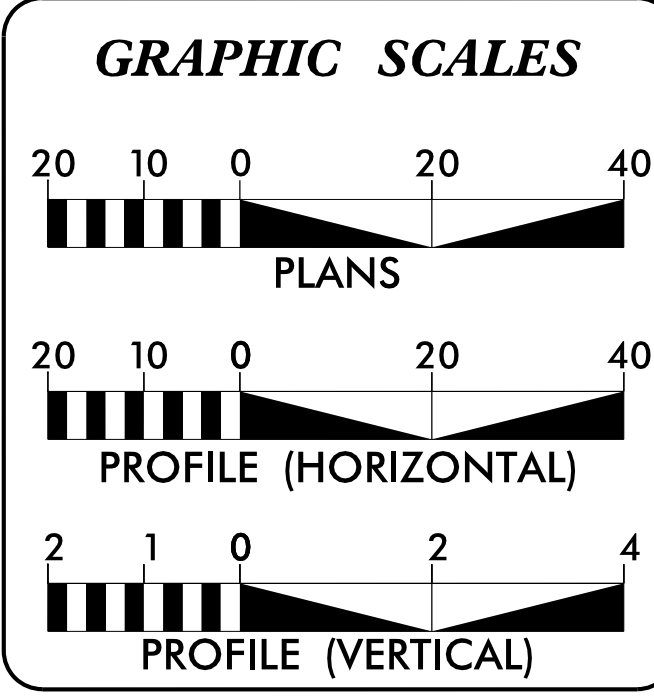

DESIGN DATA

ADT 2017 = 33,700

K = 10 %
 D = 60 %
 T = 4 % *
 V = 50 MPH

* TTST = 1% DUAL 3%

FUNC CLASS =
 URBAN PRINC. ARTERIAL
 STATEWIDE TIER

PROJECT LENGTH

LENGTH OF ROADWAY TIP PROJECT U-5950 = 0.048 MILES

TOTAL LENGTH OF TIP PROJECT U-5950 = 0.048 MILES

Prepared for the North Carolina Department of Transportation in the office of:

PLANS PREPARED BY:

PARSONS
5840 Corporate Park, Suite 217
 Raleigh, NC 27617
 REG. PROFESSIONAL ENGINEER
 NO. LICENSE NO. 74248

SUNGATE DESIGN GROUP, P.A.
200 JAMES HARRISON ROAD
 SUITE 1000
 RALEIGH, NC 27604
 REG. PROFESSIONAL ENGINEER
 NO. LICENSE NO. 74248

2018 STANDARD SPECIFICATIONS

RIGHT OF WAY DATE:
 OCTOBER 17, 2019

LETTING DATE:
 NOVEMBER 19, 2020

DAVID L. WILVER, PE
 PROJECT ENGINEER

J. MATTHEW PICKENS, PE
 PROJECT DESIGN ENGINEER

ERIC MURRAY
 NCDOT CONTACT

HYDRAULICS ENGINEER

SIGNATURE: _____ P.E.

ROADWAY DESIGN ENGINEER

SIGNATURE: _____ P.E.

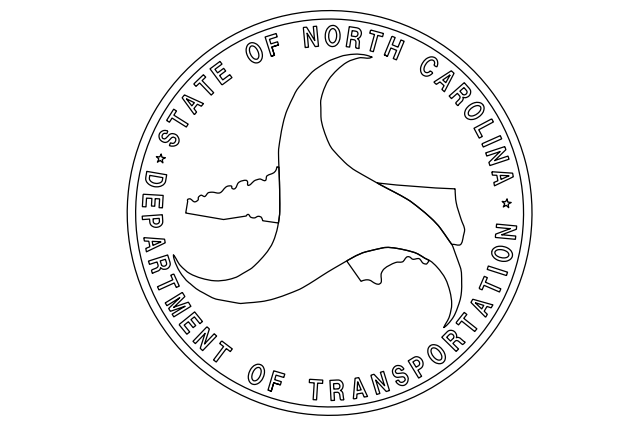

18-JUL-2019 10:27
 J:\U-5950\Roadway\Proj\U-5950_RDY_TSH_01.dgn
 \$\$\$USERNAME\$\$\$

STATE OF NORTH CAROLINA, DIVISION OF HIGHWAYS

CONVENTIONAL PLAN SHEET SYMBOLS

12/2/2016

BOUNDARIES AND PROPERTY:

State Line	-----
County Line	-----
Township Line	-----
City Line	-----
Reservation Line	-----
Property Line	-----
Existing Iron Pin	○ EIP
Computed Property Corner	-----
Property Monument	□ ECM
Parcel/Sequence Number	①23
Existing Fence Line	-x-x-x-
Proposed Woven Wire Fence	○
Proposed Chain Link Fence	□
Proposed Barbed Wire Fence	◇
Existing Wetland Boundary	----- WLB
Proposed Wetland Boundary	----- WLB
Existing Endangered Animal Boundary	----- EAB
Existing Endangered Plant Boundary	----- EPB
Existing Historic Property Boundary	----- HPB
Known Contamination Area: Soil	☠-s-☠
Potential Contamination Area: Soil	☠-s-☠
Known Contamination Area: Water	☠-w-☠
Potential Contamination Area: Water	☠-w-☠
Contaminated Site: Known or Potential	☠?

BUILDINGS AND OTHER CULTURE:

Gas Pump Vent or U/G Tank Cap	○
Sign	○ S
Well	○ W
Small Mine	⌵
Foundation	□
Area Outline	□
Cemetery	□
Building	□
School	□
Church	□
Dam	▬

HYDROLOGY:

Stream or Body of Water	-----
Hydro, Pool or Reservoir	-----
Jurisdictional Stream	----- JS
Buffer Zone 1	----- BZ 1
Buffer Zone 2	----- BZ 2
Flow Arrow	←
Disappearing Stream	-----
Spring	○
Wetland	-----
Proposed Lateral, Tail, Head Ditch	-----
False Sump	-----

RAILROADS:

Standard Gauge	-----
RR Signal Milepost	○ MILEPOST 35
Switch	□ SWITCH
RR Abandoned	-----
RR Dismantled	-----

RIGHT OF WAY & PROJECT CONTROL:

Secondary Horiz and Vert Control Point	◆
Primary Horiz Control Point	○
Primary Horiz and Vert Control Point	◆
Exist Permanent Easement Pin and Cap	◇
New Permanent Easement Pin and Cap	◆
Vertical Benchmark	⊠
Existing Right of Way Marker	△
Existing Right of Way Line	-----
New Right of Way Line	----- R/W
New Right of Way Line with Pin and Cap	----- R/W
New Right of Way Line with Concrete or Granite R/W Marker	----- R/W
New Control of Access Line with Concrete C/A Marker	----- C/A
Existing Control of Access	----- C/A
New Control of Access	----- C/A
Existing Easement Line	----- E
New Temporary Construction Easement	----- E
New Temporary Drainage Easement	----- TDE
New Permanent Drainage Easement	----- PDE
New Permanent Drainage / Utility Easement	----- DUE
New Permanent Utility Easement	----- PUE
New Temporary Utility Easement	----- TUE
New Aerial Utility Easement	----- AUE

ROADS AND RELATED FEATURES:

Existing Edge of Pavement	-----
Existing Curb	-----
Proposed Slope Stakes Cut	----- C
Proposed Slope Stakes Fill	----- F
Proposed Curb Ramp	----- CR
Existing Metal Guardrail	-----
Proposed Guardrail	-----
Existing Cable Guiderail	-----
Proposed Cable Guiderail	-----
Equality Symbol	⊕
Pavement Removal	-----

VEGETATION:

Single Tree	○
Single Shrub	○

Note: Not to Scale

*S.U.E. = Subsurface Utility Engineering

Hedge	-----
Woods Line	-----
Orchard	-----
Vineyard	----- Vineyard

EXISTING STRUCTURES:

MAJOR:	
Bridge, Tunnel or Box Culvert	----- CONC
Bridge Wing Wall, Head Wall and End Wall	----- CONC WW
MINOR:	
Head and End Wall	----- CONC HW
Pipe Culvert	-----
Footbridge	-----
Drainage Box: Catch Basin, DI or JB	----- CB
Paved Ditch Gutter	-----
Storm Sewer Manhole	----- S
Storm Sewer	----- S

UTILITIES:

POWER:	
Existing Power Pole	●
Proposed Power Pole	○
Existing Joint Use Pole	●
Proposed Joint Use Pole	○
Power Manhole	⊕
Power Line Tower	⊠
Power Transformer	⊠
U/G Power Cable Hand Hole	-----
H-Frame Pole	●
U/G Power Line LOS B (S.U.E.*)	----- P
U/G Power Line LOS C (S.U.E.*)	----- P
U/G Power Line LOS D (S.U.E.*)	----- P

TELEPHONE:

Existing Telephone Pole	●
Proposed Telephone Pole	○
Telephone Manhole	⊕
Telephone Pedestal	⊠
Telephone Cell Tower	⊠
U/G Telephone Cable Hand Hole	-----
U/G Telephone Cable LOS B (S.U.E.*)	----- T
U/G Telephone Cable LOS C (S.U.E.*)	----- T
U/G Telephone Cable LOS D (S.U.E.*)	----- T
U/G Telephone Conduit LOS B (S.U.E.*)	----- TC
U/G Telephone Conduit LOS C (S.U.E.*)	----- TC
U/G Telephone Conduit LOS D (S.U.E.*)	----- TC
U/G Fiber Optics Cable LOS B (S.U.E.*)	----- T FO
U/G Fiber Optics Cable LOS C (S.U.E.*)	----- T FO
U/G Fiber Optics Cable LOS D (S.U.E.*)	----- T FO

WATER:

Water Manhole	⊕
Water Meter	○
Water Valve	⊗
Water Hydrant	⊕
U/G Water Line LOS B (S.U.E.*)	-----
U/G Water Line LOS C (S.U.E.*)	-----
U/G Water Line LOS D (S.U.E.*)	-----
Above Ground Water Line	----- A/G Water

TV:

TV Pedestal	⊕
TV Tower	⊗
U/G TV Cable Hand Hole	-----
U/G TV Cable LOS B (S.U.E.*)	----- TV
U/G TV Cable LOS C (S.U.E.*)	----- TV
U/G TV Cable LOS D (S.U.E.*)	----- TV
U/G Fiber Optic Cable LOS B (S.U.E.*)	----- TV FO
U/G Fiber Optic Cable LOS C (S.U.E.*)	----- TV FO
U/G Fiber Optic Cable LOS D (S.U.E.*)	----- TV FO

GAS:

Gas Valve	◇
Gas Meter	⊕
U/G Gas Line LOS B (S.U.E.*)	----- G
U/G Gas Line LOS C (S.U.E.*)	----- G
U/G Gas Line LOS D (S.U.E.*)	----- G
Above Ground Gas Line	----- A/G Gas

SANITARY SEWER:

Sanitary Sewer Manhole	⊕
Sanitary Sewer Cleanout	⊕
U/G Sanitary Sewer Line	----- SS
Above Ground Sanitary Sewer	----- A/G Sanitary Sewer
SS Forced Main Line LOS B (S.U.E.*)	----- FSS
SS Forced Main Line LOS C (S.U.E.*)	----- FSS
SS Forced Main Line LOS D (S.U.E.*)	----- FSS

MISCELLANEOUS:

Utility Pole	●
Utility Pole with Base	□
Utility Located Object	○
Utility Traffic Signal Box	⊠
Utility Unknown U/G Line LOS B (S.U.E.*)	-----
U/G Tank; Water, Gas, Oil	-----
Underground Storage Tank, Approx. Loc.	----- UST
A/G Tank; Water, Gas, Oil	-----
Geoenvironmental Boring	⊕
U/G Test Hole LOS A (S.U.E.*)	-----
Abandoned According to Utility Records	AATUR
End of Information	E.O.I.

PRELIMINARY PAVEMENT SCHEDULE					
CODE	DESCRIPTION	CODE	DESCRIPTION	CODE	DESCRIPTION
C1	PROP. APPROX. 3" ASPHALT CONCRETE SURFACE COURSE, TYPE S9.5B, AT AN AVERAGE RATE OF 165 LBS. PER SQ. YD. IN EACH OF TWO LAYERS.	E1	PROP. APPROX. 4" ASPHALT CONCRETE BASE COURSE, TYPE B25.0C, AT AN AVERAGE RATE OF 456 LBS. PER SQ. YD.	T	EARTH MATERIAL.
C2	PROP. APPROX. 1 1/2" ASPHALT CONCRETE SURFACE COURSE, TYPE S9.5B, AT AN AVERAGE RATE OF 165 LBS. PER SQ. YD.	R	2'-6" CURB AND GUTTER	U	EXISTING PAVEMENT
D1	PROP. APPROX. 4" ASPHALT CONCRETE INTERMEDIATE COURSE, TYPE I19.0C, AT AN AVERAGE RATE OF 456 LBS. PER SQ. YD.	S	4" CONCRETE SIDEWALK	V1	MILLING ASPHALT PAVEMENT, 1 1/2" DEPTH
NOTE: PAVEMENT EDGE SLOPES ARE 1:1 UNLESS SHOWN OTHERWISE.					
				V2	MILLING ASPHALT PAVEMENT, 3" DEPTH

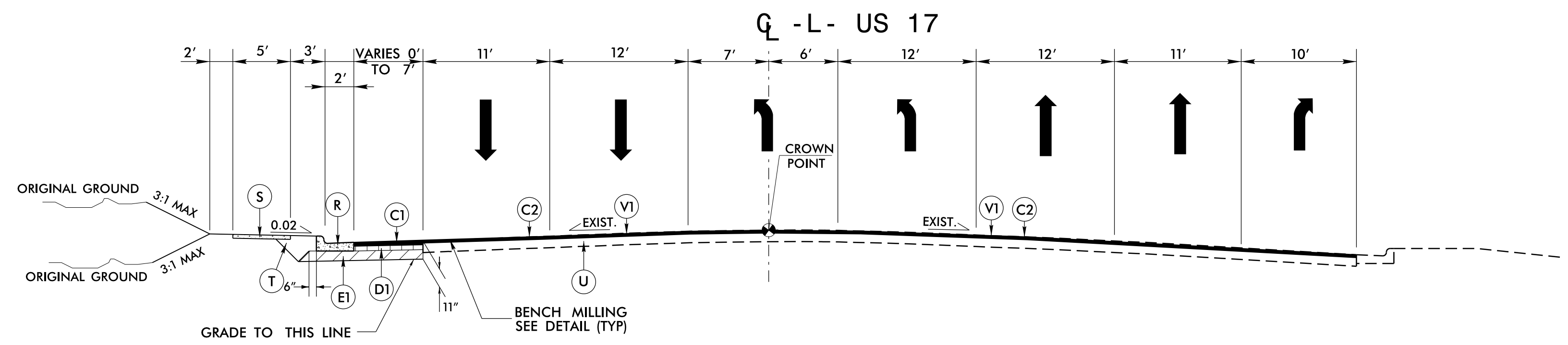

TYPICAL SECTION NO. 1
 -L- STA. 16+60.00 TO STA. 18+00.00

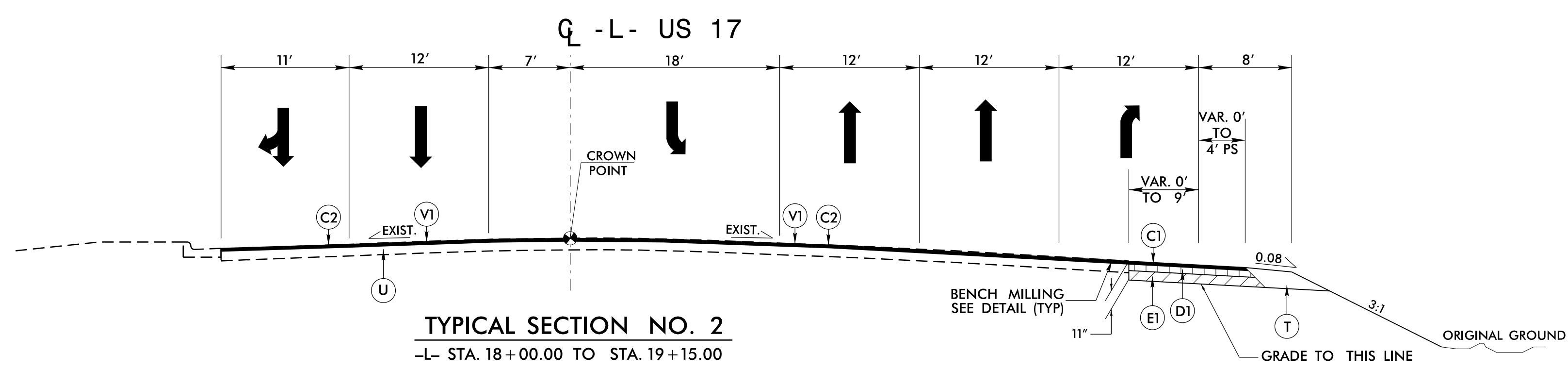

TYPICAL SECTION NO. 2
 -L- STA. 18+00.00 TO STA. 19+15.00

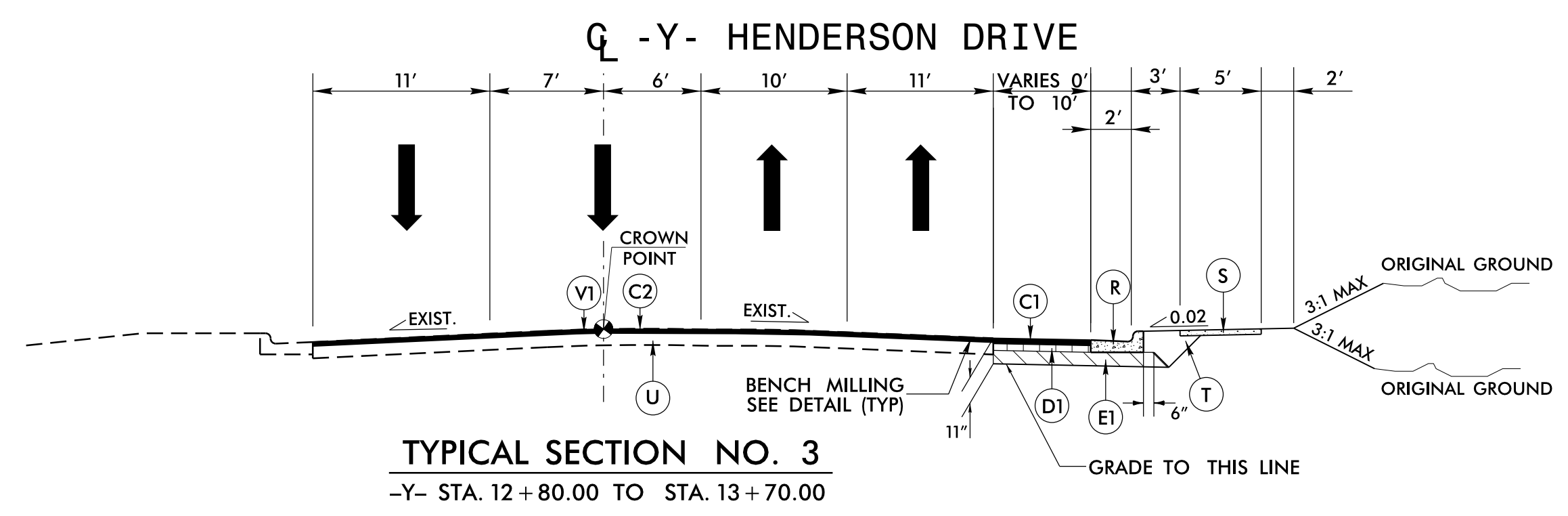

TYPICAL SECTION NO. 3
 -Y- STA. 12+80.00 TO STA. 13+70.00

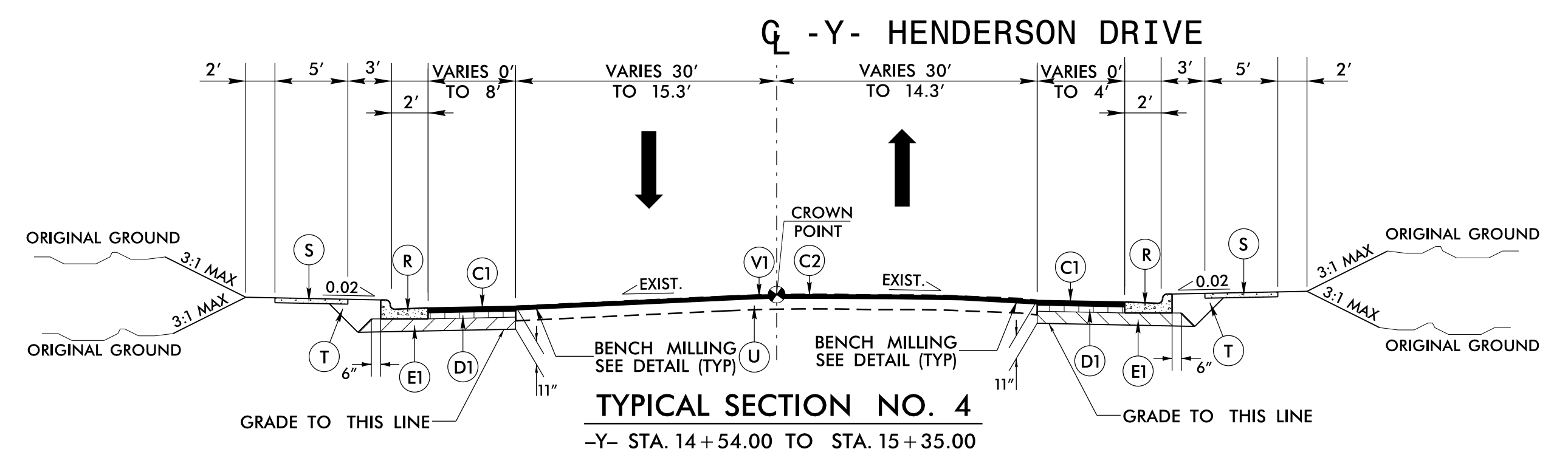

TYPICAL SECTION NO. 4
 -Y- STA. 14+54.00 TO STA. 15+35.00

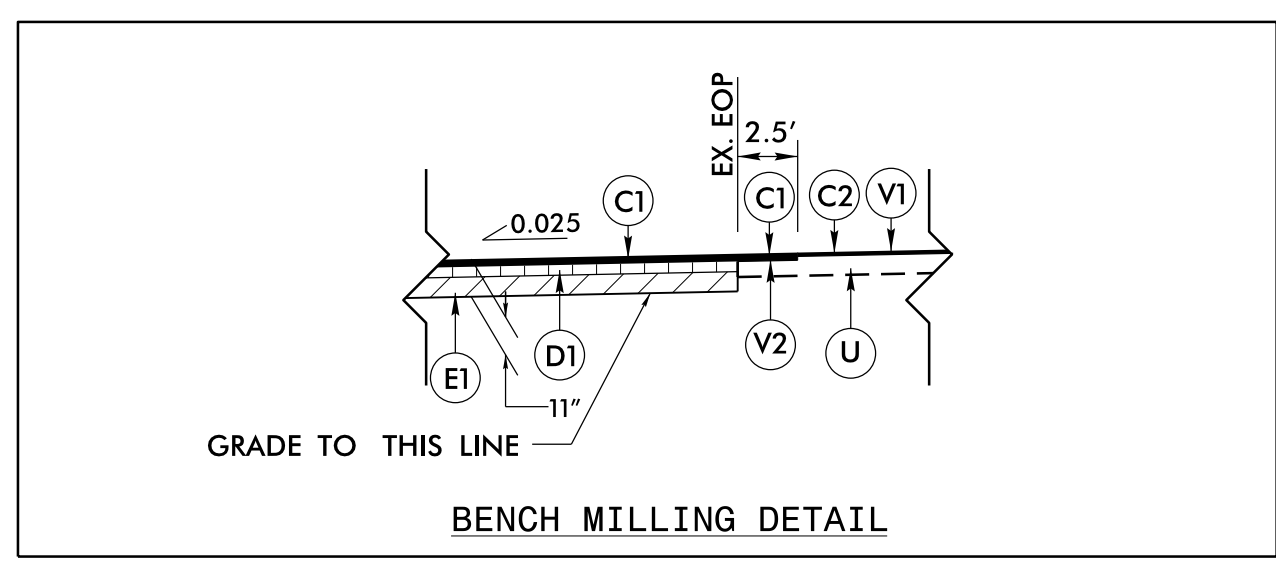

I8-111-208 10-20
 J:\15-5950\Roadway\Proj\U-5950.FRDY_TYP_02A-1.dgn
 \$\$\$USERNAME\$\$\$

5/14/99

PLANS PREPARED BY:
PARSONS
RALEIGH, NORTH CAROLINA, (919) 854-1345
NC LICENSE NO. F-0246
FOR NORTH CAROLINA DEPT. OF TRANSPORTATION

PROJECT REFERENCE NO. SHEET NO.
U-5950 2B-1
RW SHEET NO. ROADWAY DESIGN ENGINEER

DRIVEWAY WITH NCDOT MODIFIED EXPRESSWAY GUTTER DETAIL

INCOMPLETE PLANS
DO NOT USE FOR R/W ACQUISITION
PRELIMINARY PLANS
DO NOT USE FOR CONSTRUCTION

DOCUMENT NOT CONSIDERED FINAL
UNLESS ALL SIGNATURES COMPLETED

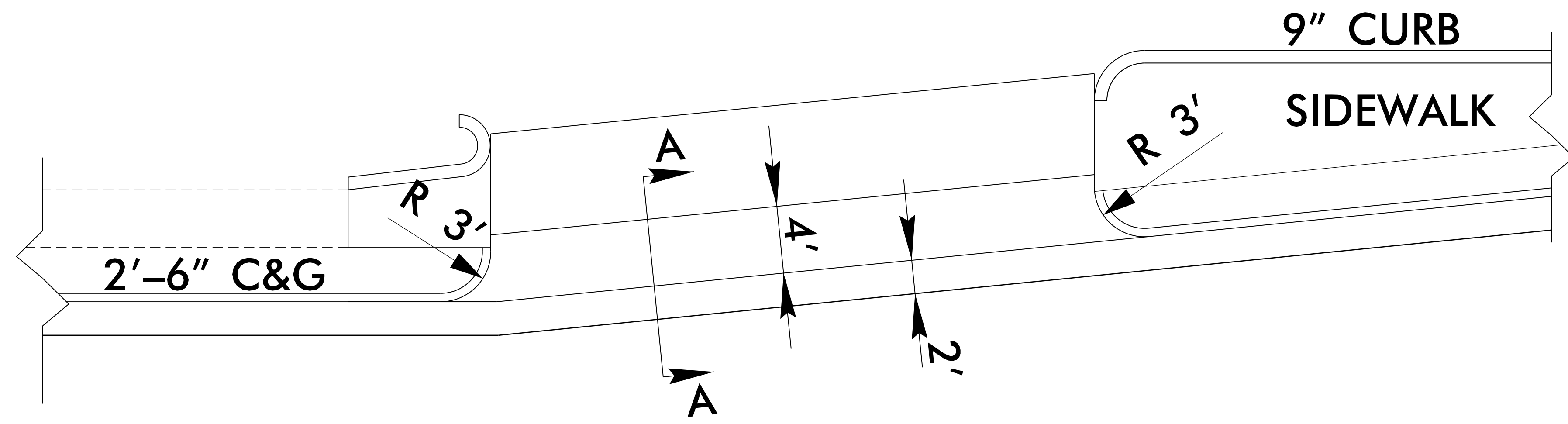

PLAN VIEW

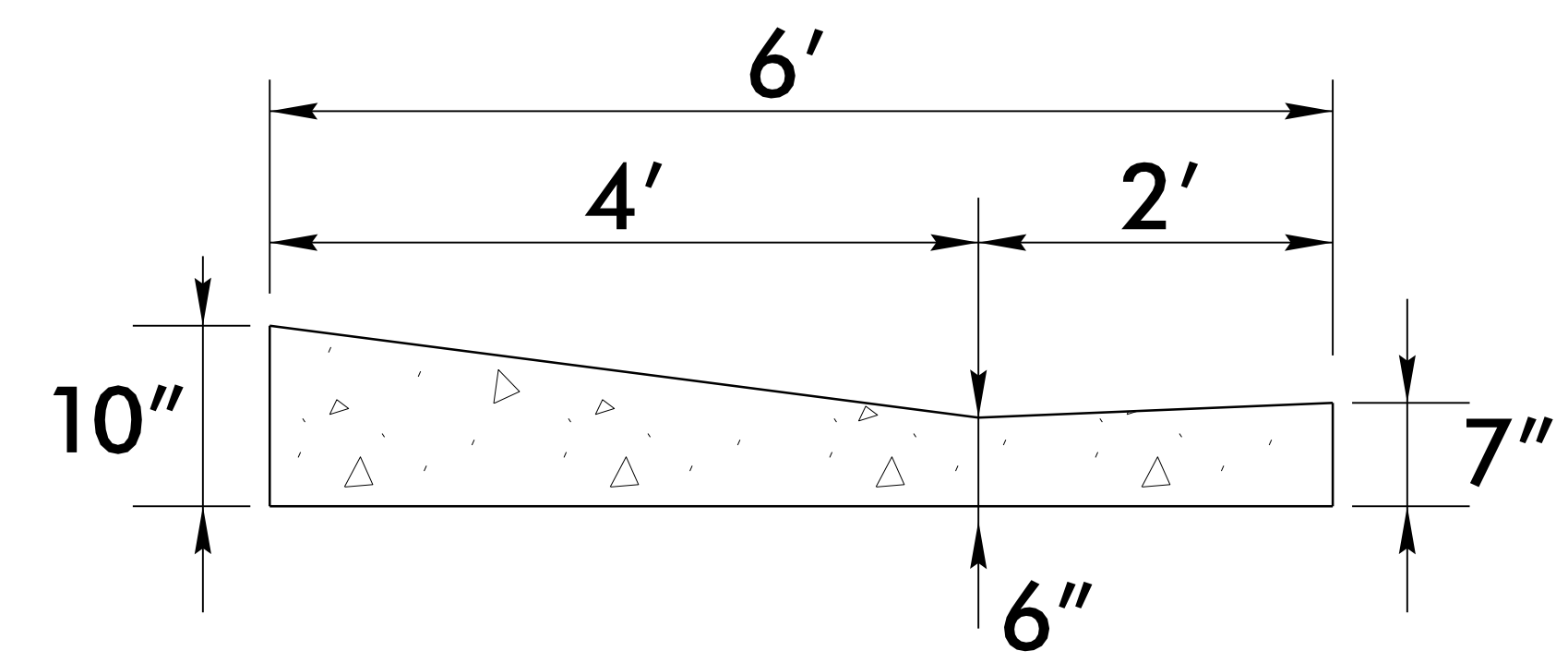

SECTION A-A

J:\U-5950\U-209\020
5/14/99 10:20 AM
J:\U-5950\U-209\020\U-5950.RDY_PSH.2B-1.dgn

STATE OF NORTH CAROLINA
 DIVISION OF HIGHWAYS

SUMMARY OF EARTHWORK

STATION	STATION	UNCL. EXCAV.	UNDERCUT	EMBANK.	BORROW	WASTE
-L- 16 + 60.00	-L- 19 + 15.00	101		23		78
-Y- 12 + 80.00	-Y- 15 + 35.00	22		28	6	
SUBTOTALS:		123		51	6	78
PROJECT TOTALS:		123		51	6	78
WASTE IN LIEU OF BORROW					-6	-6
PROJECT TOTAL		123		51		72
GRAND TOTALS:		123		51		72
SAY:		125				

Note: Approximate quantities only. Unclassified Excavation and Fine Grading will be paid for at the contract lump sum price for "Grading."

Note: Earthwork quantities are calculated by the Roadway Design Units. These quantities are based in part on subsurface data provided by the Geotechnical Engineering Unit.

DT ALBERT NEW

COMPUTED BY: DWT DATE: 7/12/19
CHECKED BY: JGD DATE: 7/12/19

PROJECT NO. SHEET NO.
U-5950 3D-1

NORTH CAROLINA DEPARTMENT OF TRANSPORTATION
DIVISION OF HIGHWAYS

Note: Invert Elevations indicated are for Bid Purposes only and shall not be used for project construction stakeout.
See "Standard Specifications For Roads and Structures, Section 300-5".

LIST OF PIPES, ENDWALLS, ETC. (FOR PIPES 48 INCHES & UNDER)

Table with columns for Line & Station, Offset, Structure Number, Pipe Details (RCP Class III, IV, V), Quantities for Drainage Structures, Frame, Grates, and Hood, Concrete Transitional Section, and Abbreviations. Includes summary rows for SHEET TOTALS and PROJECT TOTALS.

SHEET TOTALS

PROJECT TOTALS

5/14/1999
U:\19-5950\19-5950_PSDY_PSH_04.dgn
18-JUL-2019 10:27
3:58:58 PM

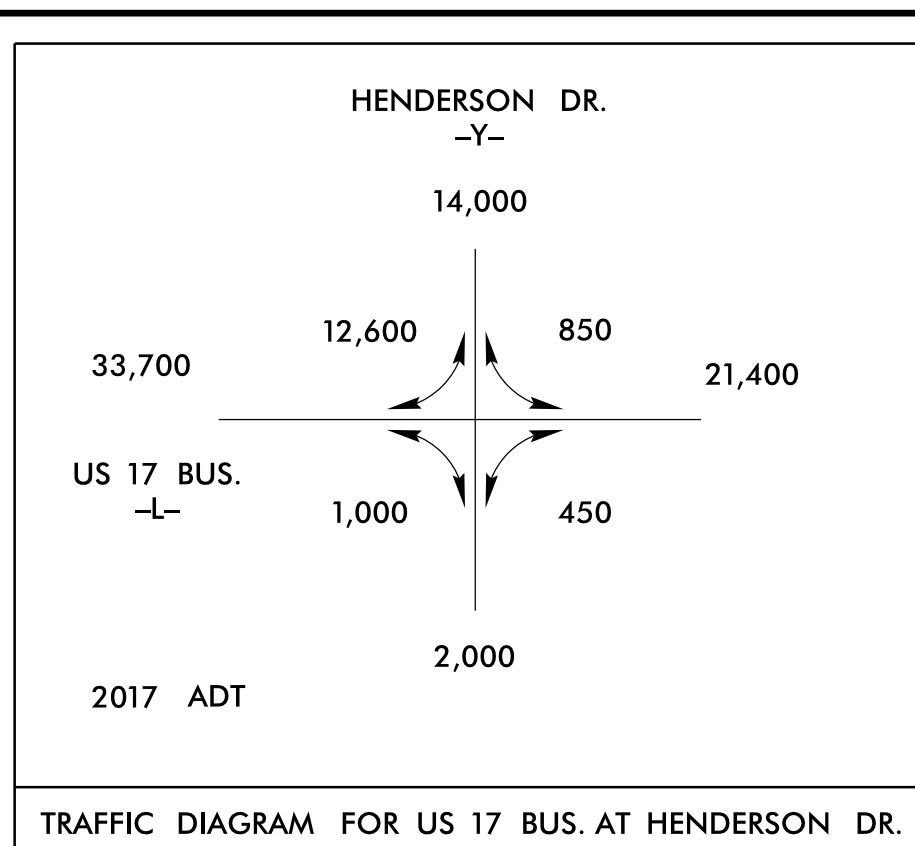

PLANS PREPARED BY:
PARSONS
RALEIGH, NORTH CAROLINA, (919) 854-1345
NC LICENSE NO. F-0246
FOR NORTH CAROLINA DEPT. OF TRANSPORTATION
SUNGATE DESIGN GROUP, P.A.
905 JONES FRANKLIN ROAD
RALEIGH, NORTH CAROLINA 27606
TEL (919) 859-2243 FAX (919) 859-6258
ENG. FIRM LICENSE NO. C490

PROJECT REFERENCE NO.	SHEET NO.
U-5950	4
R/W SHEET NO.	
ROADWAY DESIGN ENGINEER	HYDRAULICS ENGINEER
INCOMPLETE PLANS DO NOT USE FOR R/W ACQUISITION	
PRELIMINARY PLANS DO NOT USE FOR CONSTRUCTION	
DOCUMENT NOT CONSIDERED FINAL UNLESS ALL SIGNATURES COMPLETED	

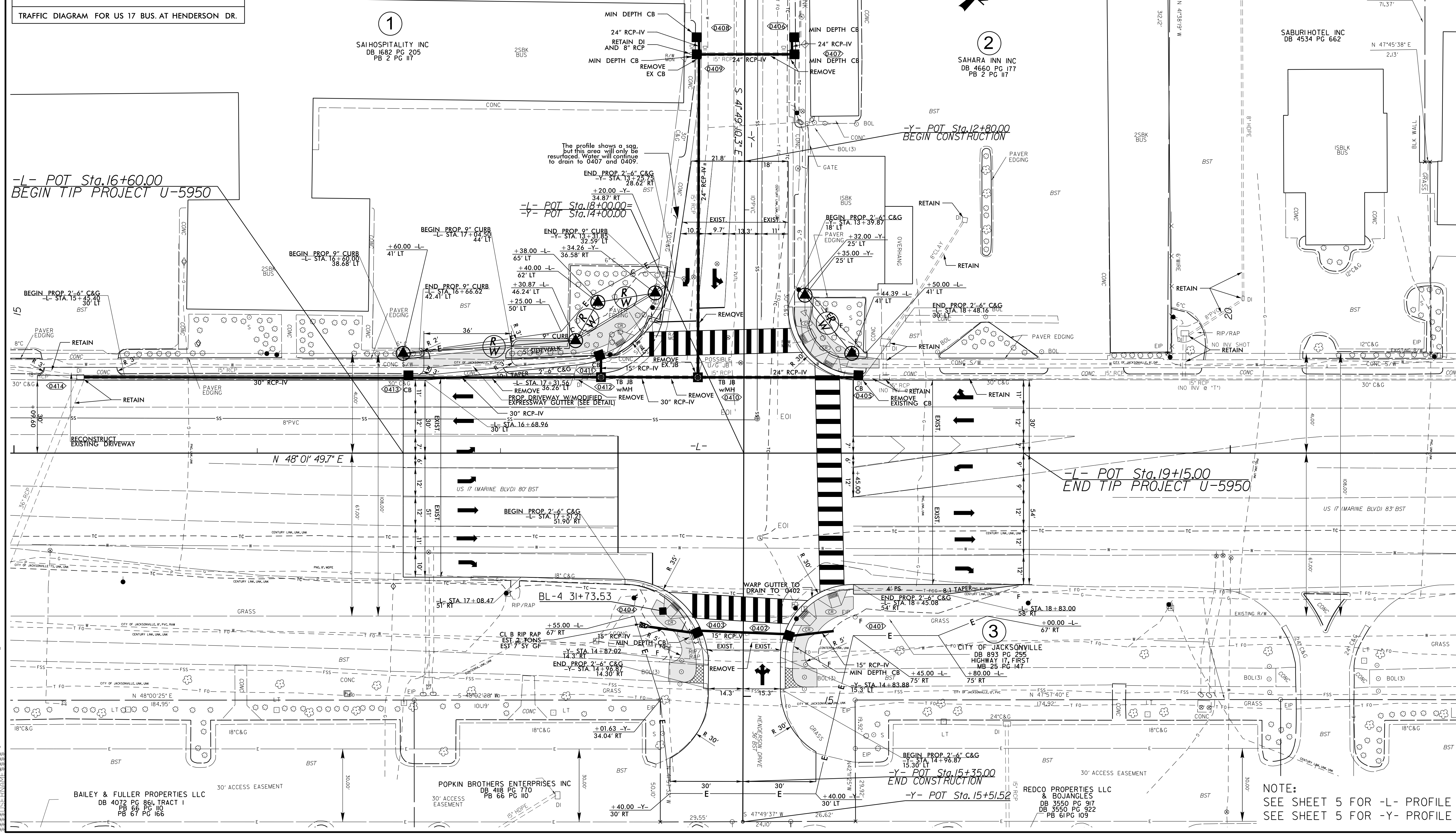

NOTE:
SEE SHEET 5 FOR -L- PROFILE
SEE SHEET 5 FOR -Y- PROFILE

5/28/99

BM #2 ELEVATION = 15.79'
N = 370830.13 E = 2475230.53
-L- STATION 12+00.87
207.63' RIGHT
BRIDGE SPIKE IN 26" PINE

BM #1 ELEVATION = 18.02'
N = 371233.82 E = 2475628.15
-L- STATION 17+66.46
173.38' RIGHT
SQUARE CUT AT TOP OF CURB

PLANS PREPARED BY :

PARSONS
RALEIGH, NORTH CAROLINA, (919) 854-1345
NC LICENSE NO. F-0246
FOR NORTH CAROLINA DEPT. OF TRANSPORTATION

SUNGATE DESIGN GROUP, P.A.
815 JONES FRANKLIN ROAD
RALEIGH, NORTH CAROLINA 27605
TEL (919) 859-2243 FAX (919) 854-0258
ENG. REG. LICENSE NO. 6490

PROJECT REFERENCE NO. U-5950	SHEET NO. 5
ROADWAY DESIGN ENGINEER	HYDRAULICS ENGINEER
INCOMPLETE PLANS DO NOT USE FOR R/W ACQUISITION PRELIMINARY PLANS DO NOT USE FOR CONSTRUCTION	

**DOCUMENT NOT CONSIDERED FINAL
UNLESS ALL SIGNATURES COMPLETED**

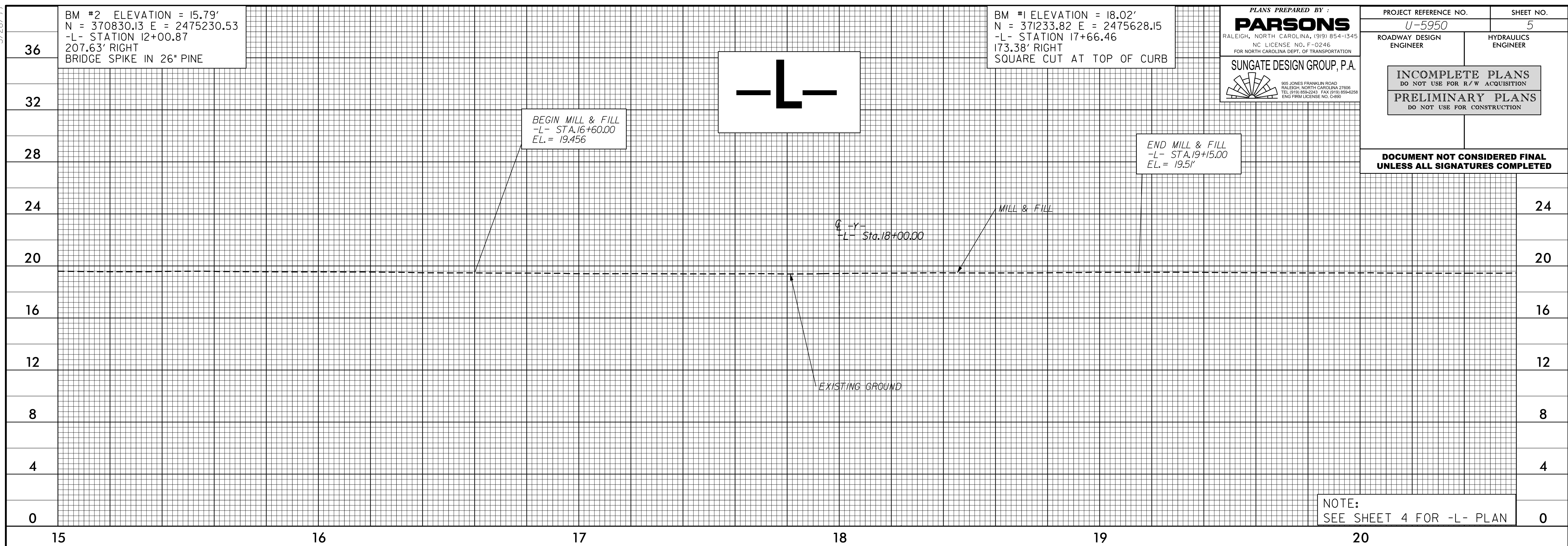

NOTE:
SEE SHEET 4 FOR -L- PLAN

10-JUL-2008 10:21
I:\Projects\5950\Roadway\Drawings\Roadway\5950_R05_PFL_05.dgn

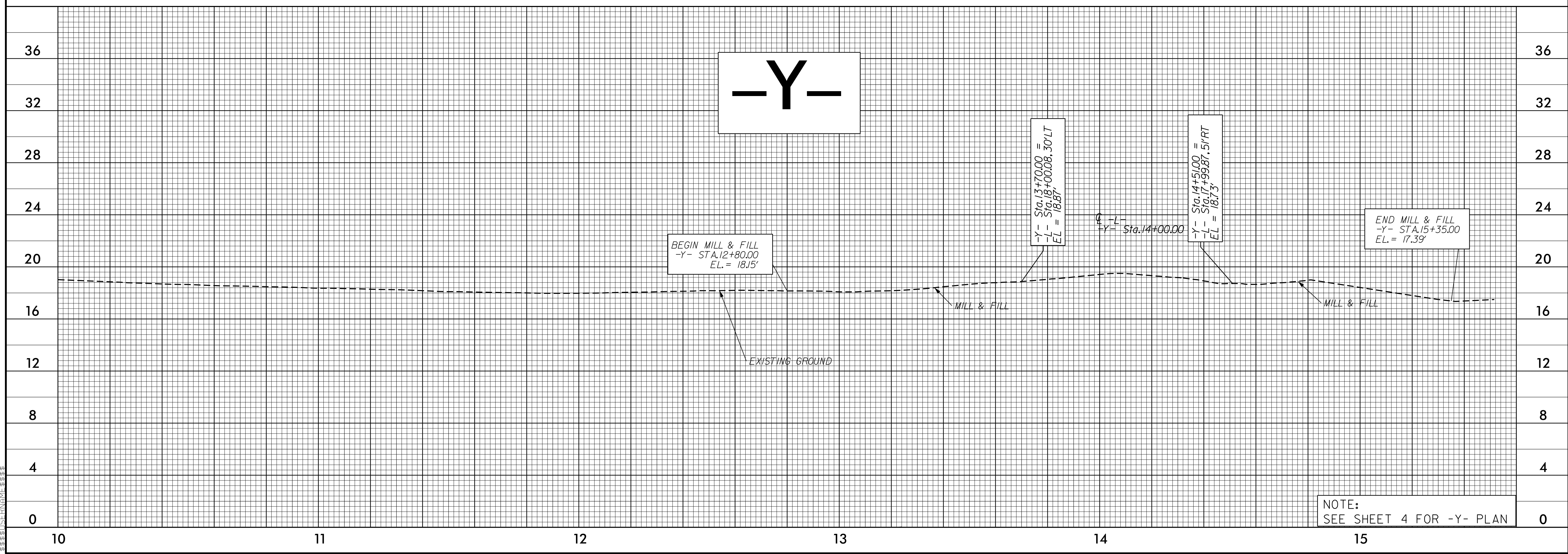

NOTE:
SEE SHEET 4 FOR -Y- PLAN

7/2/99
I:\JUL-2018-10-21
I:\JUL-2018-10-21\PROJECTS\XSC\U-5950-RDY_XPL-1A.dgn
\$\$\$\$\$ USERNAME\$\$\$\$\$

CONTRACT: TIP PROJECT: U-5950

STATE OF NORTH CAROLINA
DIVISION OF HIGHWAYS

CROSS - SECTIONS

STATE	STATE PROJECT REFERENCE NO.	SHEET NO.	TOTAL SHEETS
N.C.	U-5950	X-1A	6
STATE PROJ. NO.	F.A. PROJ. NO.	DESCRIPTION	

INCOMPLETE PLANS
DO NOT USE FOR R/W ACQUISITION

SECTIONS
CROSS-SECTION TITLE SHEET
CROSS-SECTION SUMMARY
STA. 16+60.00 -L- TO STA. 19+15.00 -L-
STA. 12+80.00 -Y- TO STA. 15+35.00 -Y-

SHEET NO's.
X-1A
X-1B
X-1 THRU X-2
X-3 THRU X-4

STATE OF NORTH CAROLINA
DIVISION OF HIGHWAYS

Approximate quantities only. Unclassified excavation, borrow excavation, fine grading, clearing and grubbing and removal of existing pavement will be paid for at the lump sum price for "Grading".

CROSS-SECTION SUMMARY

Station	Uncl. Exc.	Embt	Station	Uncl. Exc.	Embt	Station	Uncl. Exc.	Embt	Station	Uncl. Exc.	Embt	Station	Uncl. Exc.	Embt	Station	Uncl. Exc.	Embt
-L-	(cu. yd.)	(cu. yd.)	-Y-	(cu. yd.)	(cu. yd.)		(cu. yd.)	(cu. yd.)		(cu. yd.)	(cu. yd.)		(cu. yd.)	(cu. yd.)		(cu. yd.)	(cu. yd.)
16+60.00	0	0	12+80.00	0	0												
16+65.00	0	0	13+00.00	0	0												
16+80.00	5	1	13+20.00	0	0												
17+00.00	8	1	13+40.00	11	0												
17+20.00	14	1	14+60.00	0	0												
17+40.00	23	1	14+80.00	8	14												
17+60.00	15	1	14+85.00	1	4												
17+80.00	0	2	15+00.00	2	4												
18+00.00	0	0	15+20.00	0	0												
18+20.00	0	0	15+35.00	0	0												
18+40.00	18	7															
18+60.00	9	2															
18+80.00	5	1															
19+00.00	4	1															
19+15.00	0	0															

8/17/99
 I:\JUL-2008_10-21
 U-5950\XSC\U-5950_RDY_XPL_1B.dgn
 \$\$\$USER\$\$\$

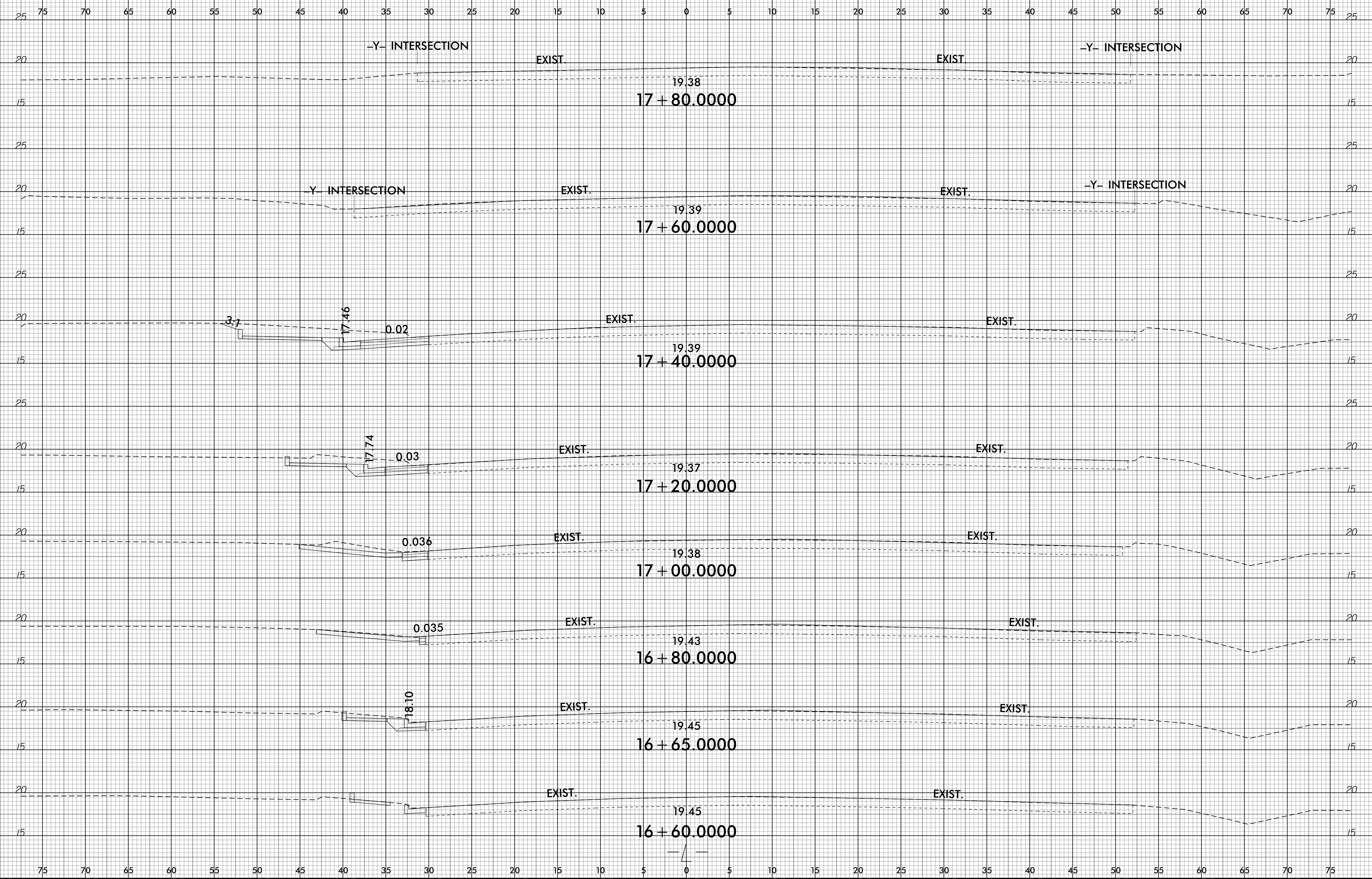
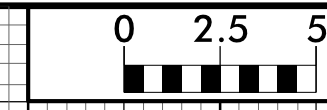

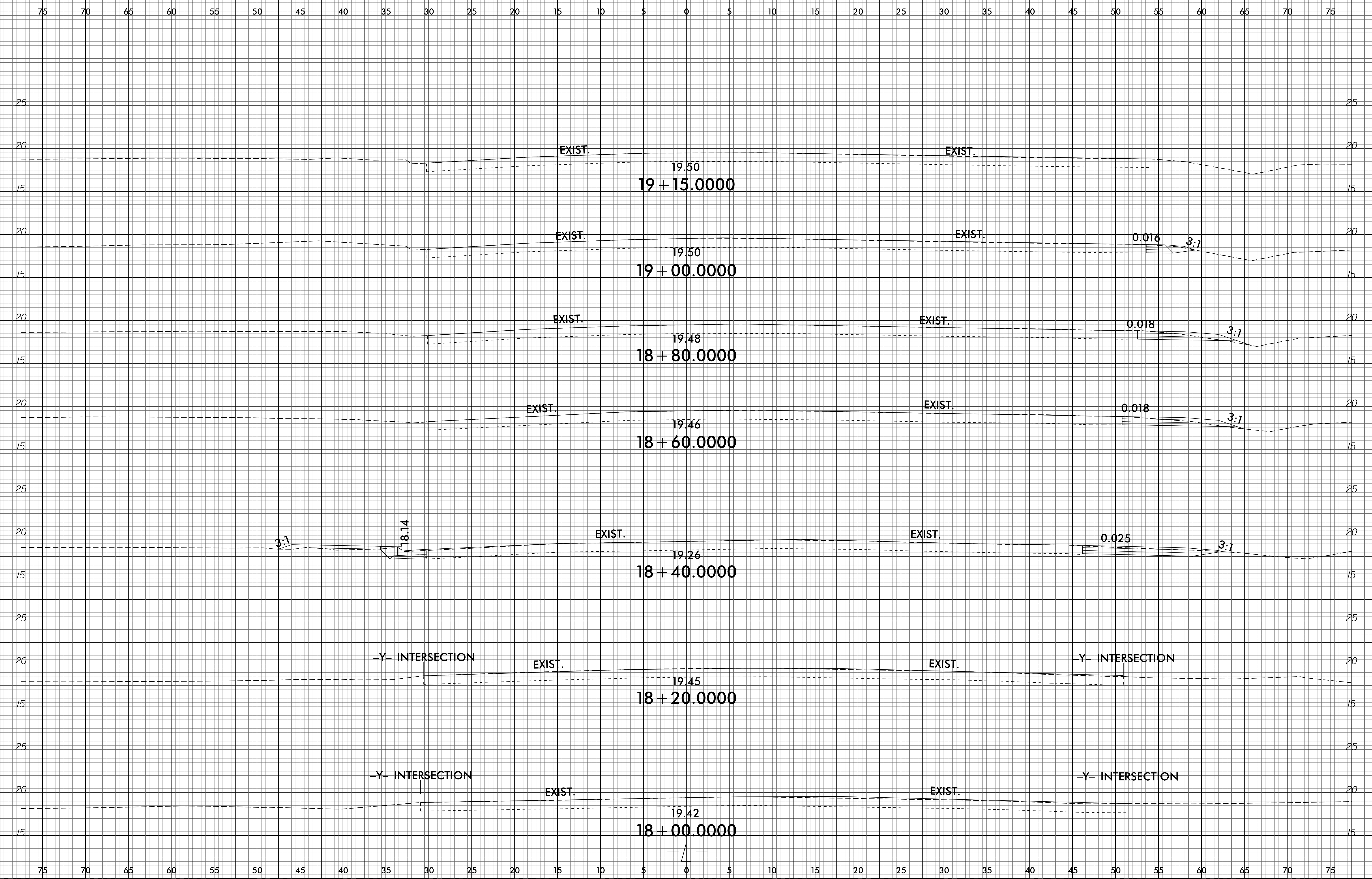
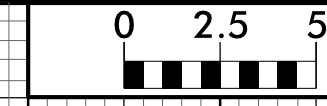

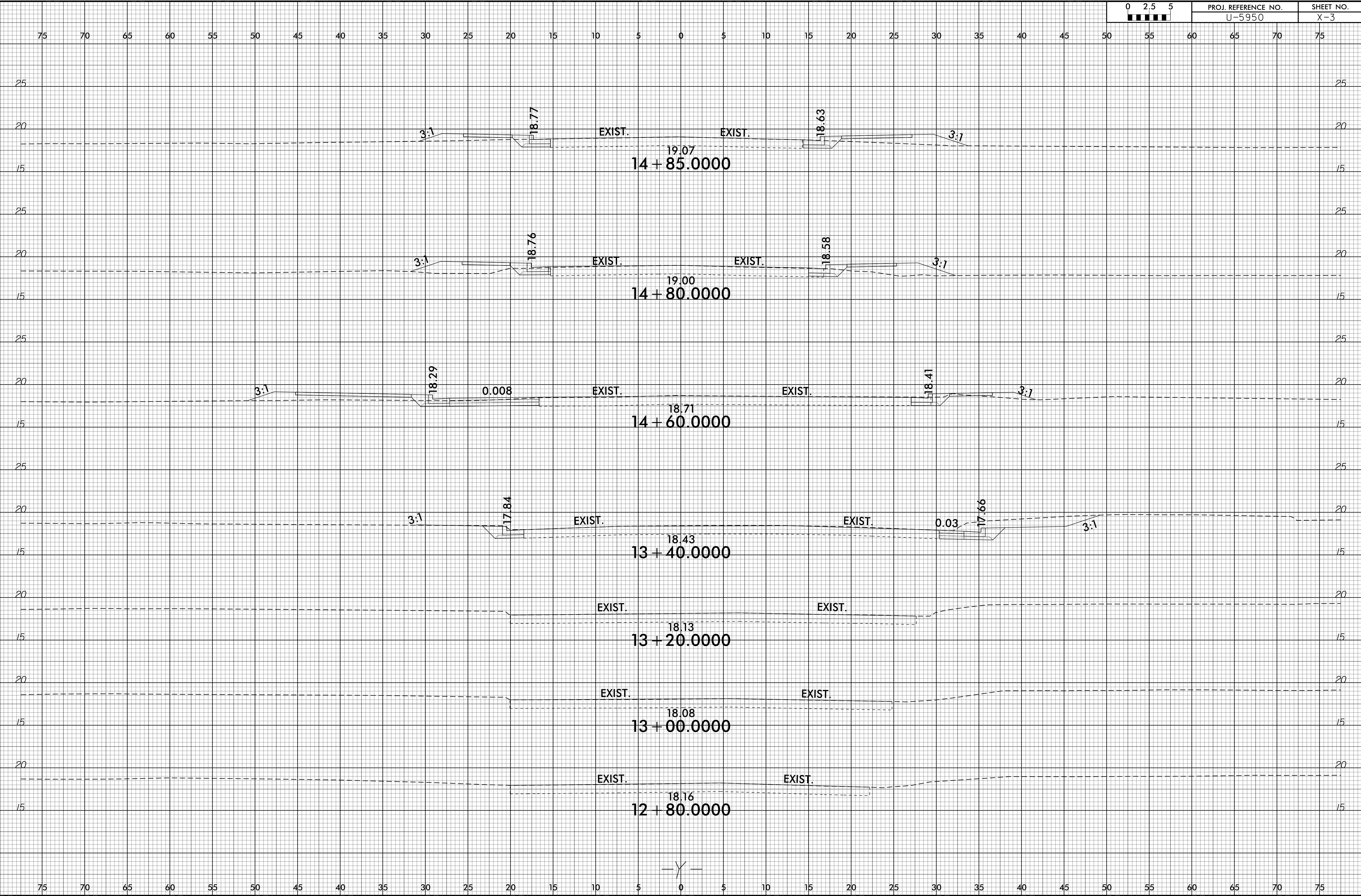
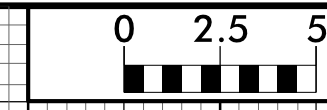

Y

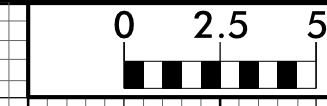

75 70 65 60 55 50 45 40 35 30 25 20 15 10 5 0 5 10 15 20 25 30 35 40 45 50 55 60 65 70 75

